

## Sustainable Gateways

Small ports – sustainable gateways to coastal national parks CB630



Photo: Metsähallitus / Sanna-Kaisa Juvonen.

# FINAL REPORT ON INVESTMENT ACTIVITIES ON ÖRÖ

## SUSTAINABLE GATEWAYS

# FINAL REPORT ON INVESTMENT ACTIVITIES ON ÖRÖ CB630 SUSTAINABLE GATEWAYS PROJECT

## 1. NEW HARBOUR RECEPTION BUILDING ON ÖRÖ

The procurement for the first phase of the construction of the harbour reception building was undertaken by Metsähallitus, Parks & Wildlife Finland between August 2018 and October 2018. The procurement for the second phase of construction took place between March 2019 and May 2019. Procurement was carried out in two phases, as the project budget needed to be adjusted in order to cover the cost of the construction.



Construction drawing of Öro harbour building. Drawing: LPR-arkkitehdit Oy.

The construction of the building started in December 2018 and it was finished and available for use in June 2020.

The building houses a harbour reception and a harbour shop as well as an information point for visitors.



The location of the new harbour reception building on Öro at the onset of construction work. Photo: Metsähallitus / Matti Peltonen.



The new harbour reception building on Öro. Photo: Metsähallitus / Sanna-Kaisa Juvonen.



The new harbour reception building on Öro. Photo: Metsähallitus / Sanna-Kaisa Juvonen.



The new harbour reception building on Öro. Photo: Metsähallitus / Sanna-Kaisa Juvonen.



The new harbour reception building on Öro. Photo: Metsähallitus / Sanna-Kaisa Juvonen.



The interior of the harbour reception building. Photo: Metsähallitus / Sanna-Kaisa Juvonen.



The interior of the harbour reception building. Photo: Metsähallitus / Sanna-Kaisa Juvonen.

## 2. HARBOUR EXPANSION ON ÖRÖ

As an initial step, the procurement was undertaken for the planning of the expansion of the harbour by Metsähallitus, Parks & Wildlife Finland. As a follow-up step, the expansion plans were completed for the harbour.

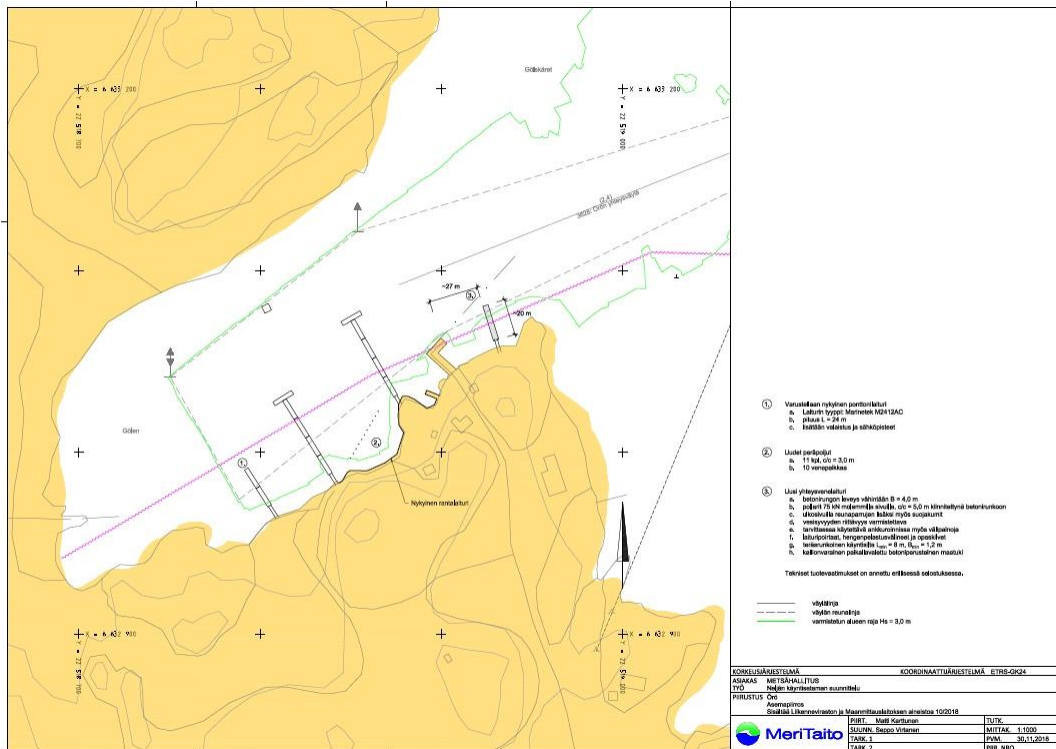

Örö harbour site plan. Drawing: Meritaito Oy.

The procurement for the implementation of the harbour expansion plan took place between February 2020 and March 2020. The harbour expansion was implemented in June 2020. The harbour expansion was completed and ready for use in the summer season of 2020.

A new jetty for bigger boats was installed. This allows, for example, bigger boats to be moored while they wait for their passengers during their visit. The jetty has two mooring sites, allowing two big boats to be moored at the same time. In addition, ten new buoys were installed to increase the mooring capacity of the harbour.

One older jetty was supplied with electricity and lights and is ready to be connected to the island's electricity system. The electricity substation on the island was adapted to receive the connection from the jetty. The connection of the jetty to the island's electricity system via the substation will take place in 2021. This work will be financed by Metsähallitus, Parks & Wildlife Finland.



Ten new buoys were installed in Örö harbour. Photo: Metsähallitus / Sanna-Kaisa Juvonen.



Ten new buoys were installed in Örö harbour. Photo: Metsähallitus / Sanna-Kaisa Juvonen.





The new jetty for big boats on Öro. Photo: Metsähallitus / Sanna-Kaisa Juvonen.



The new jetty for big boats on Öro. Photo: Metsähallitus / Sanna-Kaisa Juvonen.



The white arrow shows the older jetty that was supplied with electricity and lights. It will be connected to the island's electricity network in 2021. Photo: Metsähallitus / Sanna-Kaisa Juvonen.

### 3. UPDATED INFORMATION BOARDS

The content of the information boards was updated. New information boards were procured, and the updated information boards were installed on Öro.



The updated information boards on Öro. Photo: Metsähallitus / Sanna-Kaisa Juvonen.



The updated information boards on Öro. Photo: Metsähallitus / Sanna-Kaisa Juvonen.



The updated information boards on Örö. Photo: Metsähallitus / Jussi Helimäki.



The updated information boards on Örö. Photo: Metsähallitus / Jussi Helimäki.



The updated information boards on Öro. Photo: Metsähallitus / Jussi Helimäki.



The updated information boards on Öro. Photo: Metsähallitus / Sanna-Kaisa Juvonen.



The updated information boards on Öro. Photo: Metsähallitus / Sanna-Kaisa Juvonen.